



Wireless Remote Switch H1 (Double Rocker) Specifications

Lumi United Technology Co., Ltd.

all rights reserved

Contents

1. Product introduction	4
1.1. Product overview	4
1.2. Product View	4
1.3. Selling points	5
2. Product parameters	5
2.1. Product parameters	5
2.2. Electrical parameters	6
2.3. Wireless parameters	6
2.4. Environmental parameters	7
3. Product instructions	7
3.1. LED status description	7
3.2. Instructions on button functions	8
3.3. Instructions for installation	8
4. Product test information	12
4.1. Reliability test and quality test	12
4.2. Verification information	13



Revision record

Revision	Revision Content	Revised by	Revised on
V1.0	1.Initial release	Mei Zhang	2021-1-26



1. Product introduction

1.1. Product overview

The Aqara Wireless Remote Switch H1 (Double Rocker) is a new wireless remote switch. It supports single press in the high-speed click mode, and different functions in the multi-function mode including single press left button, single press right button, double press left button, double press right button, long press left button and long press right button. It is able to be placed or attached anywhere indoors. It also works with the Aqara hub and other Aqara smart devices to implement a variety of smart scenes.

* An Aqara hub is required. Some functions require specific models of the Aqara hub. Please visit www.aqara.com/support for more details.

1.2. Product View





1.3. Selling points

The Wireless Switch H1 can control any of your Aqara Zigbee 3.0 devices, even if your internet connection or smart home hub goes down. Stick the Wireless Switch H1 to any place you want and control the light from two different places: the H1 will work exactly like a hard-wired 2-way switch with a 5-year battery life.

- (a) Zigbee 3.0 Protocol
- (b) Five-Year Battery Life
- (c) Flexible Installation
- (d) 7 Configurable Actions

2. Product parameters

2.1. Product parameters

Category	Description
Brand	Aqara
Name	Wireless Remote Switch H1 (Double Rocker)
Model	WRS-R02
Item Dimensions:	85.8 × 86 × 12.5 mm
Color	White
Material	PC
Gross weight	142g

Net weight	120g
Secondary Packaging weight	1.08kg
Package Dimensions	93.5*92.5*30mm
Secondary Packaging Dimensions	32.7*36.7*32cm

2.2. Electrical parameters

Category	Description
Battery Type	CR2450
Input voltage	3V
Battery Capacity:	620mAh
Battery Life	5 Years

2.3. Wireless parameters

Category	Description
Wireless connection	Zigbee 3.0
Wireless standard	IEEE 802.15.4

Zigbee Frequency Range	2405-2480 MHz
Zigbee Power Transmission	≤13 dB
Communication distance	30m (Indoor)

2.4. Environmental parameters

Category	Description
Operating temperature	-10°C ~ +50°C
Storage temperature	-20°C ~ +60°C
Operating humidity	0-95% RH, no condensation

3. Product instructions

3.1. LED status description

Indicator Status	Description
Blue light flashes once	Button press detected
Flash once every 2s for 20s	Binding
Blue light flashes 2 times	Bound successfully
Continuous blue for 1s	Failed to bind

3.2. Instructions on button functions

Button Pressing	Description
Press once for any/both rockers	Default
Press 5 times or more for any/both rockers	Effective Range Test and pairing with Hub
Press for 10 seconds for any/both rockers	Reset Network connection

3.3. Instructions for installation

3.3.1 This product works with Aqara Home app. You can scan the following QR code to download the Aqara Home app from the Apple App store. Android users can find the Aqara Home app on Google Play. With the Aqara Home app, it can work with other Aqara smart devices.



1. Before activating the accessory, please make sure you have downloaded the Aqara



Home app and the Aqara hub that supports Zigbee 3.0 installed.

2. Please open the app, go to the homepage and select “+” in the top right corner to enter Add Accessory page. Select “Aqara Wireless Remote Switch H1 (Double Rocker)” and add it according to the instructions.

3. Please visit www.aqara.com/support for more information.

3.3.2 Effective Range Test: After it is bound with the hub, put the device at the preferred location and press the button of the device quickly for 5 times, if the hub makes voice prompts, it indicates that the accessory can communicate effectively with the hub.

*To ensure stable connections, please avoid setting up the device on metallic surfaces.

Option 1: Adhesive-free, place it on a surface directly.

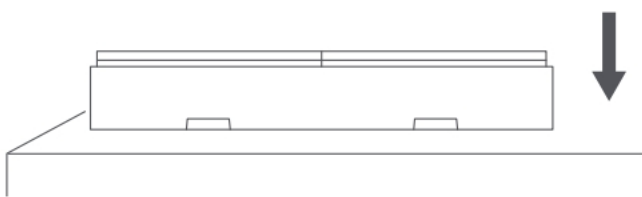

Option 2: Remove the protective film from the adhesive tape and attach the device on the desired surface.

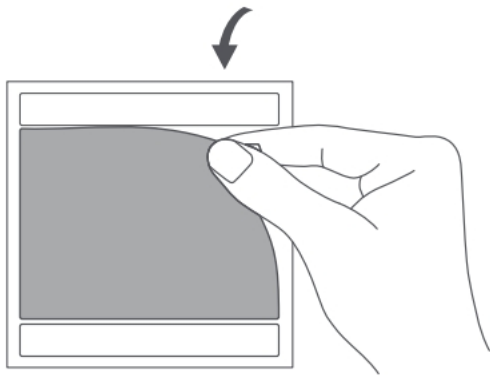

*Please keep the surface clean and dry.

Option 3: Open the back of the Wireless Remote Switch H1 (Double Rocker) with a flat-blade screwdriver, drill through the thin piece at the screw of the back cover with a sharp tool or an electric drill (Attention! Make sure you are drilling the back cover, not the main part of the switch that incorporates hardware and buttons), fix it to the wall box with the screw that comes with the box, and then put the cover of the Wireless Remote Switch H1 (Double Rocker) back.

1. Open the back of the Wireless Remote Switch H1 (Double Rocker) with a screwdriver.

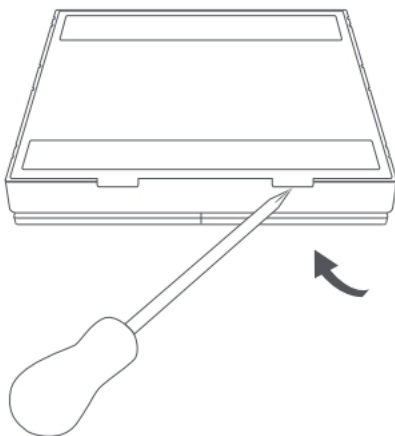

2. Drill through the back cover with an awl/electric drill to install the screw.

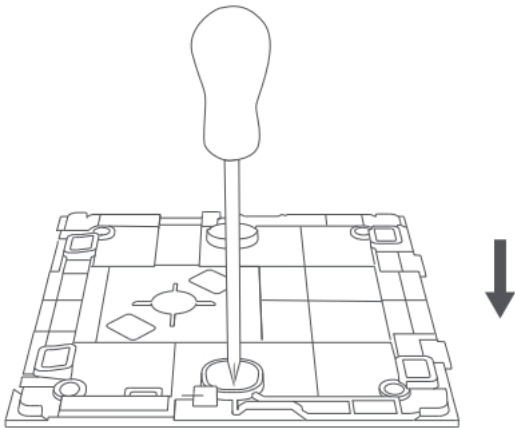

3. Fix the screw and put the cover back.

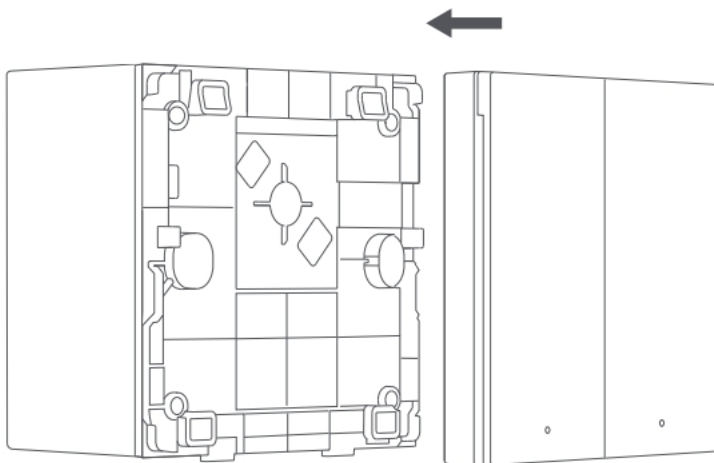

4. Product test information

4.1. Reliability test and quality test

Name	Content	Description	Source
Wireless Remote Switch H1 (Double Rocker)	Drop test	1000mm	Tested by third party
	High and low temperature test	-20°C~55°C	Tested by third party
	Aging	48 hours	Tested by third party
	Press times	50000 times	Tested by Aqara
	Shell material	RoHS report	Provided by the supplier

4.2. Verification information

Country/Region	Identification Name
EU	CE RED
	RoHS-EU
	REACH
	POPs
	WEEE

	Packaging
	Battery Directive
UK	UKCA
Russia	EAC COC
	EAEU RoHS
	FAC
Singapore	SIRIM
Malaysia	IMDA
Global Scale	Homekit
	Zigbee Alliance